

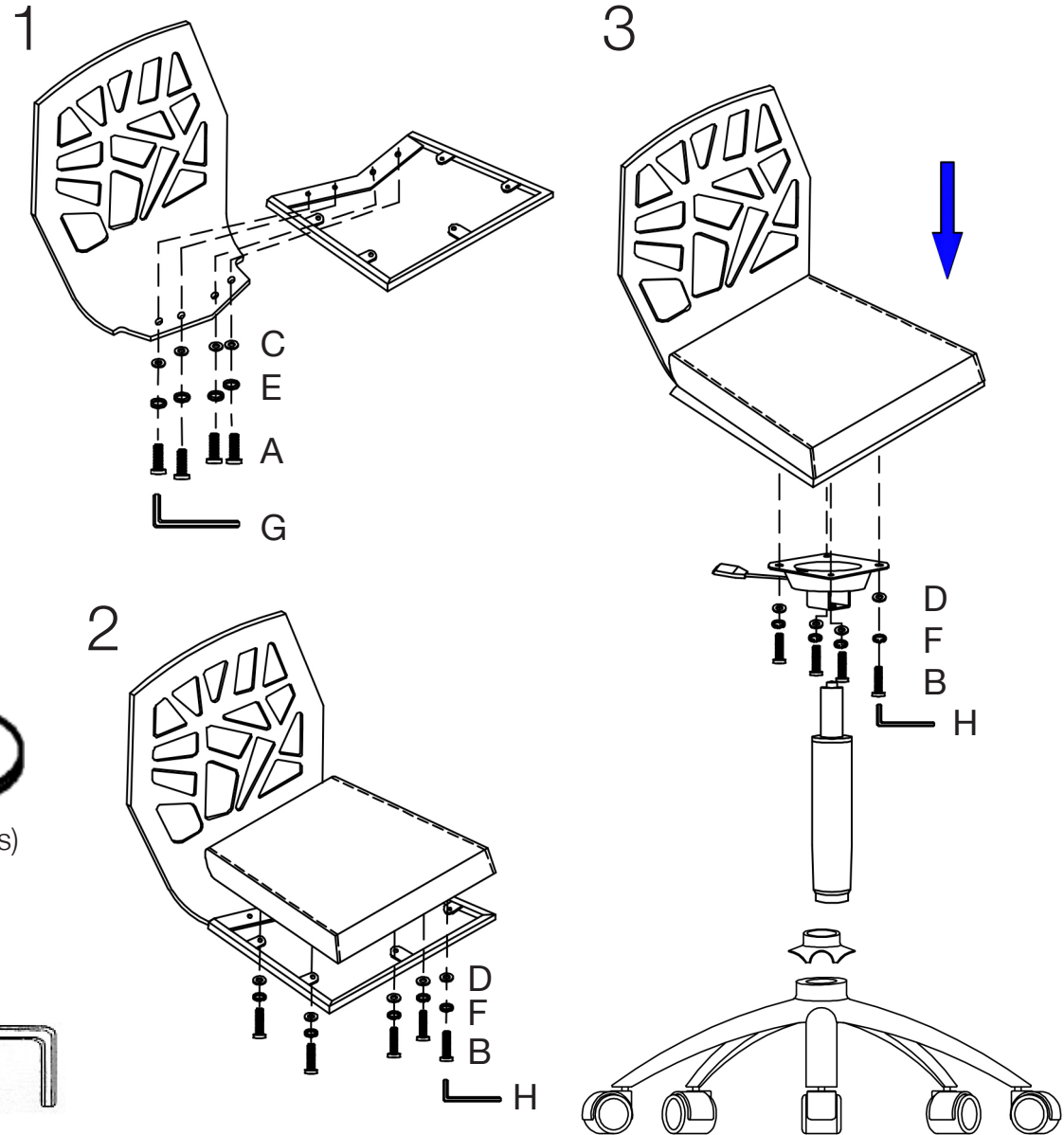

Assembly Instructions

SOPHIA Armless Office Chair

PLEASE NOTE: Check that you have received all components and hardware before assembling.
If you are missing any parts fax Euro Style at 415.455.8033 or email: claims@gotoeurostyle.com



A (4 pcs)
M5/16" X 7/8mm



B (9 pcs)
M1/4" X 5/8mm



C (4 pcs)



D (9 pcs)



E (4 pcs)



F (9 pcs)

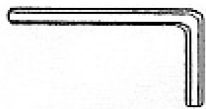

G (1 pc)
5mm

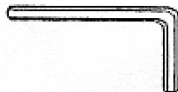

H (1 pc)
4mm

During assembly, hand tighten screws only. When all screws are in place, then tighten completely.