

Assembly Instructions FENELLA Office Chair



- | | | | |
|-----------|--|-----------|--|
| A (1 pc) | | H (6 pcs) | |
| | | M6 x 25mm | |
| B (1 pc) | | I (2 pcs) | |
| | | M6 x 30mm | |
| C (2 pcs) | | J (2 pcs) | |
| | | M8 x 40mm | |
| D (1 pc) | | K (8 pcs) | |
| | | | |
| E (1 pc) | | L (2 pcs) | |
| | | M8 x 50mm | |
| F (1 pc) | | M (2 pcs) | |
| | | | |
| G (5 pcs) | | N (1 pc) | |
| | | M6 | |
| | | O (1 pc) | |
| | | M8 | |

Revised 09.21.15 ar

PLEASE NOTE: Check that you have received all components and hardware before assembling. If you are missing any parts fax Euro Style at 415.455.8033 or email: claims@gotoeurostyle.com

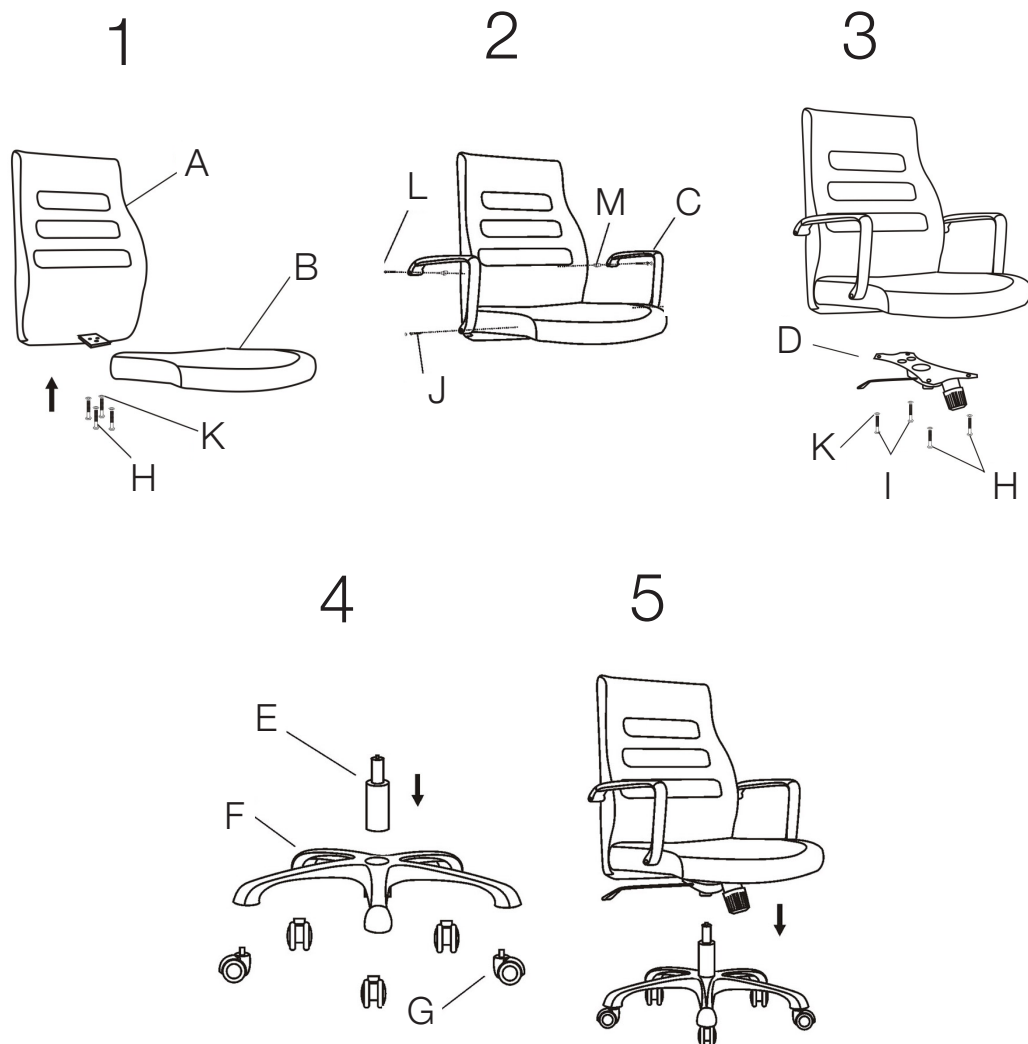

During assembly, hand tighten screws only. When the screws are in place, tighten completely.